

Front view and mounting

Add gearbox
ratio 5.18

Side view

Rear view

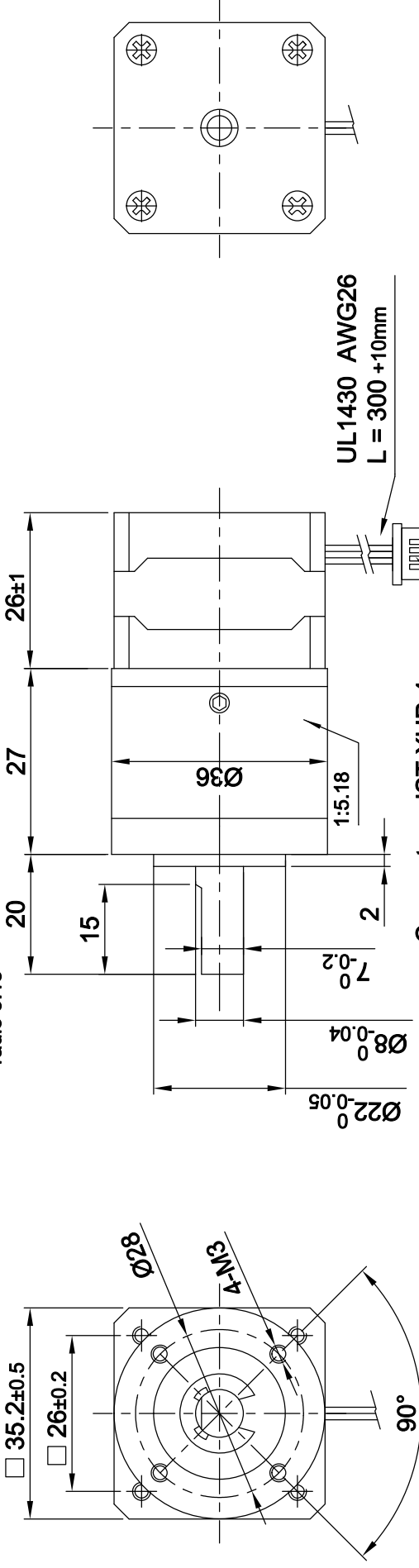

Connector: JST XHP-4
Contact: SXH-001T-P0.6

SPECIFICATION	CONNECTION	BIPOLAR
VOLTAGE (VDC)		3.2
AMPS/PHASE		0.8
RESISTANCE/PHASE (Ohms)@25°C		4±15%
INDUCTANCE/PHASE (mH) @1KHz		2.3±20%
HOLDING TORQUE (Nm) [lb-in]		0.24 [2.102]
DETENT TORQUE (Nm) [lb-in]		2.55x10 ⁻³ [0.023]
STEP ANGLE (°)		1.8
STEP ACCURACY (NON-ACCUM)		±5%
ROTOR INERTIA (kg-m ²) [lb-in ²]		1.0x10 ⁻⁶ [0.0034]
WEIGHT (kg) [lb]		0.345 [0.7613]
TEMPERATURE RISE: MAX.80°C (MOTOR STANDSTILL; FOR 2 PHASE ENERGIZED)		
AMBIENT TEMPERATURE -10~ 50°C [14°F ~ 122°F]		
INSULATION RESISTANCE 100 MΩhm (UNDER NORMAL TEMPERATURE AND HUMIDITY)		
INSULATION CLASS B 130° [266°F]		
DIELECTRIC STRENGTH 500VAC FOR 1 MIN. (BETWEEN THE MOTOR COILS AND THE MOTOR CASE)		
AMBIENT HUMIDITY MAX. 85% (NO CONDENSATION)		

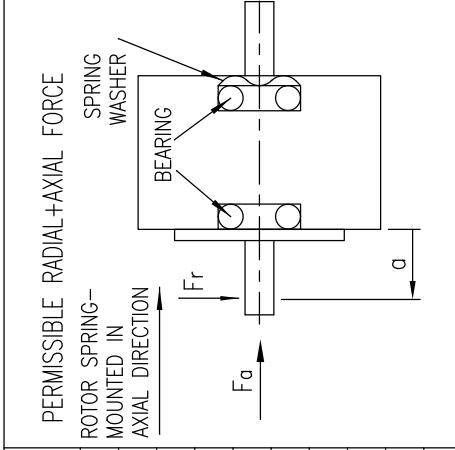

AXIAL-FORCE Fa (N)	Fa=10
DISTANCE a (mm)	5 10 15 20
RADIAL-FORCE Fr (N)	58 36 26 20
	AXIAL RADIAL
SHAFT PLAY (mm)	0.08 0.02
AT LOAD MAX: (N)	4.5 4.5

TYPE OF CONNECTION (EXTERN)		MOTOR	
PIN NO	BIPOLAR	LEADS	WINDING
1	A —	BRN	A
2	A \	ORG	A \
3	B —	RED	B
4	B \	YEL	B \

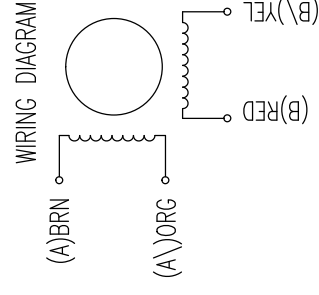

Nanotec
PLUG & DRIVE

General tolerances
DIN ISO 2768- cH

Work piece edge
DIN ISO 13715

Surface specification
DIN ISO 1302

APVD	J.Ha	20.10.30
CHKD		
DRN	APVD	20.10.29
SIGNATURE		DATE

STEPPING MOTOR

DWG.NO

ST3518S0804-CYAN

REV DESCRIPTION DATE

DRN

DATE