

# 86系列行星减速步进电机-34HSG

Stepper With Gearbox Motors – NEMA 34

灵活的紧凑型步进电机，尺寸为 NEMA 34 (86 mm)，提供多种长度和不同的绕组，电机尾部可选装编码器。

Flexible compact stepper motor, size NEMA 11 (28 mm), provides a variety of lengths and different windings, motor optional encoder.

## Feature

- Stepping motor 步进电机
- 86mm small size 86系列法兰
- Encoder optional 可配套编码器
- Longer life and higher accuracy 更长的寿命和更高的精度
- Different lengths available 提供不同长度
- Motor Controllers / Drives available 电机控制器/驱动器可用

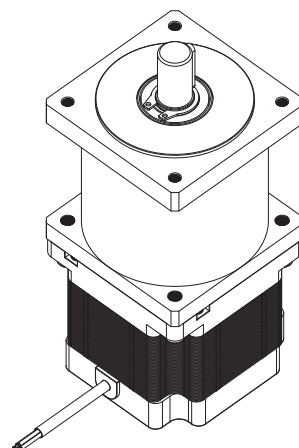

## VERSIONS

| 系列代码 Series models                  | 34HS76   | 34HS98 | 34HS112 | 34HS128 | 34HS150 |
|-------------------------------------|--|--------|---------|---------|---------|
| 相电流 Current per Winding A           | 4  | 6      | 5       | 6       | 6       |
| 静力矩 Holding Torque N.m              | 3.5  | 7      | 7.6     | 10      | 13      |
| 相电阻 Resistance per Winding Ohm      | 0.5  | 0.4    | 0.6     | 0.6     | 1.25    |
| 相电感 Inductance per Winding mH       | 3.7  | 3.8    | 5       | 5.5     | 8       |
| 转子惯量 Rotor Inertia gcm <sup>2</sup> | 1400   | 1700   | 2700    | 2800    | 3600    |
| 电机重量 Weight kg                      | 1.4  | 2.7    | 3.5     | 4.2     | 5.3     |
| 电机高度 Length "L" mm                  | 76   | 98     | 112     | 128     | 150     |
| 电机法兰 Motor flange mm                | 86   | 86     | 86      | 86      | 86      |
| 反馈装置 Feedback                       | Encoder(Closed-loop version) 500/1000/2000/4000 CPR Optional |        |         |         |         |

## 订货代号 ORDER IDENTIFIER

### 34HS76-E2000-R14

34HS76=Motor body code  
电机代号  
E2000=Encoder 2000/Resolution  
E2000=编码器 2000刻度  
R=圆出轴  
D=扁出轴

## 可选减速箱 Gearbox optional

|         |           |   |   |   |    |    |    |    |    |    |           |    |    |    |    |    |    |    |    |     |
|---------|-----------|---|---|---|----|----|----|----|----|----|-----------|----|----|----|----|----|----|----|----|-----|
| 减速比     | 4         | 5 | 7 | 9 | 10 | 16 | 20 | 25 | 28 | 35 | 36        | 40 | 45 | 49 | 50 | 63 | 70 | 81 | 90 | 100 |
| 减速级数    | 1         |   |   |   |    |    |    |    |    |    | 2         |    |    |    |    |    |    |    |    |     |
| L1 箱体长度 | 73mm      |   |   |   |    |    |    |    |    |    | 87mm      |    |    |    |    |    |    |    |    |     |
| 最大允许转矩  | 50N.m     |   |   |   |    |    |    |    |    |    | 80N.m     |    |    |    |    |    |    |    |    |     |
| 回程间隙    | <15Arcmin |   |   |   |    |    |    |    |    |    | <25Arcmin |    |    |    |    |    |    |    |    |     |
| 传动效率    | 96%       |   |   |   |    |    |    |    |    |    | 94%       |    |    |    |    |    |    |    |    |     |

## DIMENSIONS (IN MM)

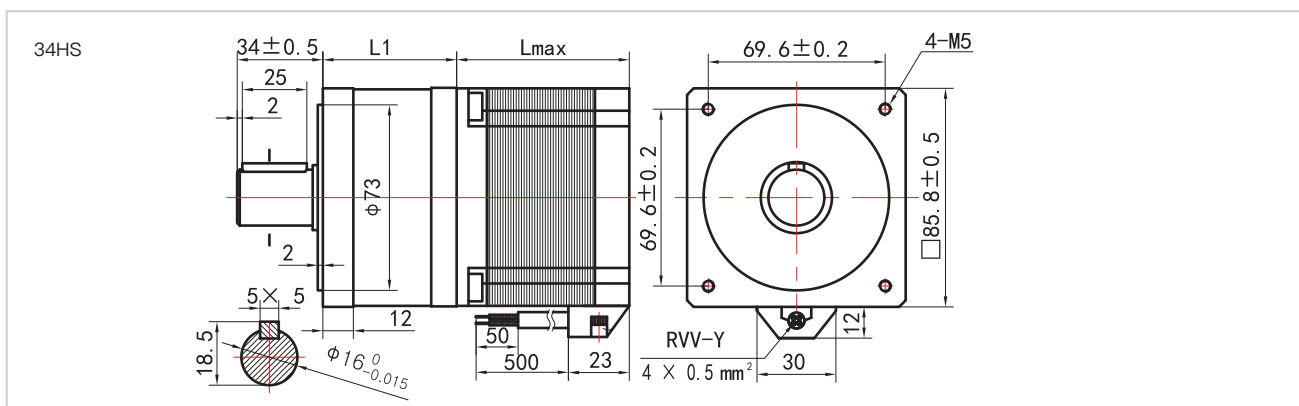

# SERVO MOTORS

## 伺服电机 · 低压伺服

Product Manual · 产品手册

