

## 57系列贯通式直线电机-23HSL

Through-shaft Linear Actuator With T-Screw – NEMA17

### DIMENSIONS (IN MM)

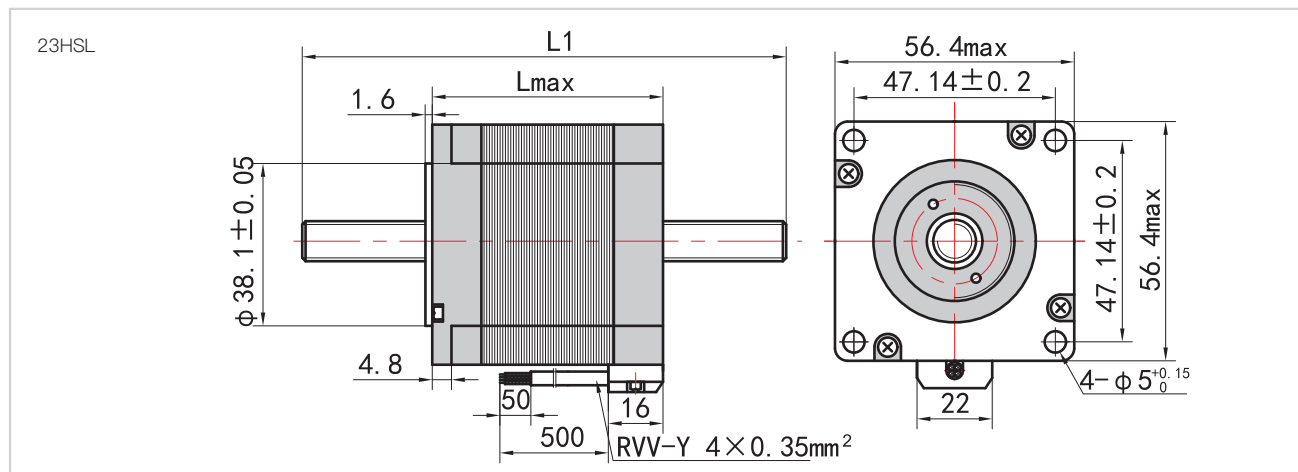

### DIMENSIONS (IN MM)

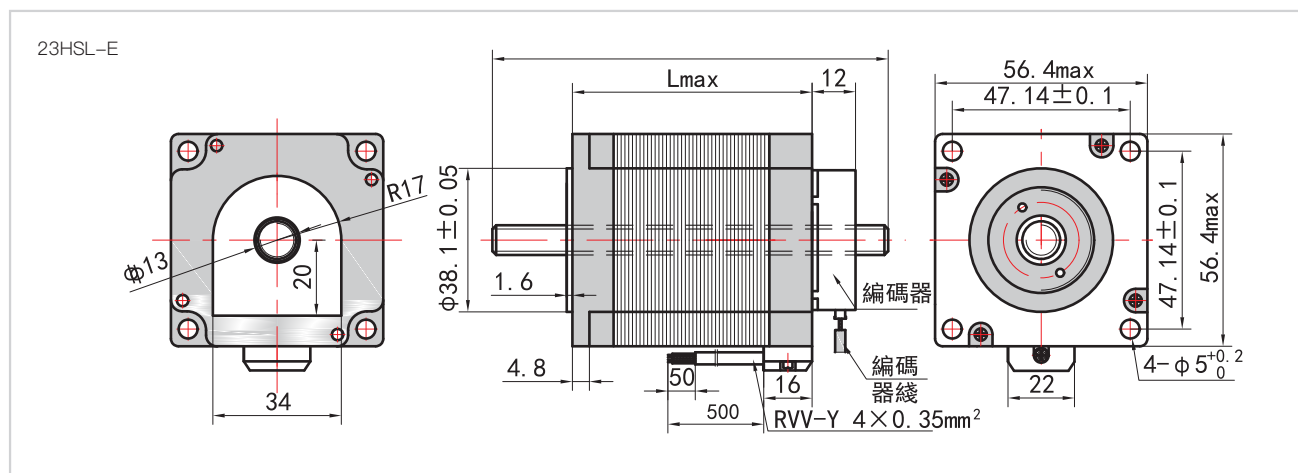

## 57系列固定轴式直线电机-23HSA

Fixed shaft Linear Actuator With T-Screw – NEMA 17

NEMA23(57mm法兰)贯通轴式直线电机是贯通式的线性执行器，结构紧凑，传动效率和定位精度高。可选装高分辨率的贯通编码器配合高定位使用  
Nema17 through-axis linear actuators integrate T screws and two-phase stepper motors. Additional encoder can also provide

### ◎ Feature

- Integrated structure 一体化结构
- Multiple specifications available 提供多种规格
- Longer life and higher accuracy 更长的寿命和更高的精度
- Different lengths available 提供不同长度
- A built-in encoder available. 提供内置编码器。
- Motor Controllers / Drives available 电机控制器/驱动器可用
- 0.0002mm/step with our controlle 使用控制器时，0.0002mm /步

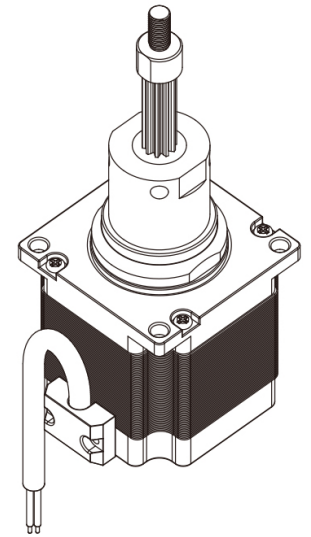

### ◎ VERSIONS

系列代码 Series models	23HS45A	23HS56A	23HS76A
相电流 Current per Winding A	2	3	4
静力矩 Holding Torque mN.m	700	1300	1600
相电阻 Resistance per Winding Ohm	1.63	1.1	0.5
相电感 Inductance per Winding mH	5.8	3.2	1.25
转子惯量 Rotor Inertia gcm <sup>2</sup>	155	280	460
电机重量 Weight kg	0.5	0.62	1
电机高度 Length "L" mm	45	56	76
螺杆长度 Screw length*L1	Different lengths available		
反馈装置 Feedback	Encoder(Closed-loop version)		

### 订货代号 ORDER IDENTIFIER

**23HS45T0502E2000-L1**  
T0502=Screw code  
丝杠代码  
  
L1 = Screw length  
丝杠长度  
  
E2000=Encoder resolution(Optional)编  
码器分辨率 (可选)

### 可选螺杆 Screw optional

Screw	Diameter	Screw lead	Step(mm)
T953-1.58	9.525	1.5875	0.0079375
T953-25.4	9.525	25.4	0.127
T10-2	10	2	0.01
T10-4	10	4	0.02
T10-10	10	10	0.05
T10-20	10	20	0.1

### 可选配件 ACCESSORIES

ZK-ENC-500 Encoder Cable 0.5m  
  
**Encoder: 500-4000PCR**  
  
**Motor Controllers / Drives**

## 57系列固定轴式直线电机-23HSA

Fixed shaft Linear Actuator With T-Screw – NEMA 23

### DIMENSIONS (IN MM)

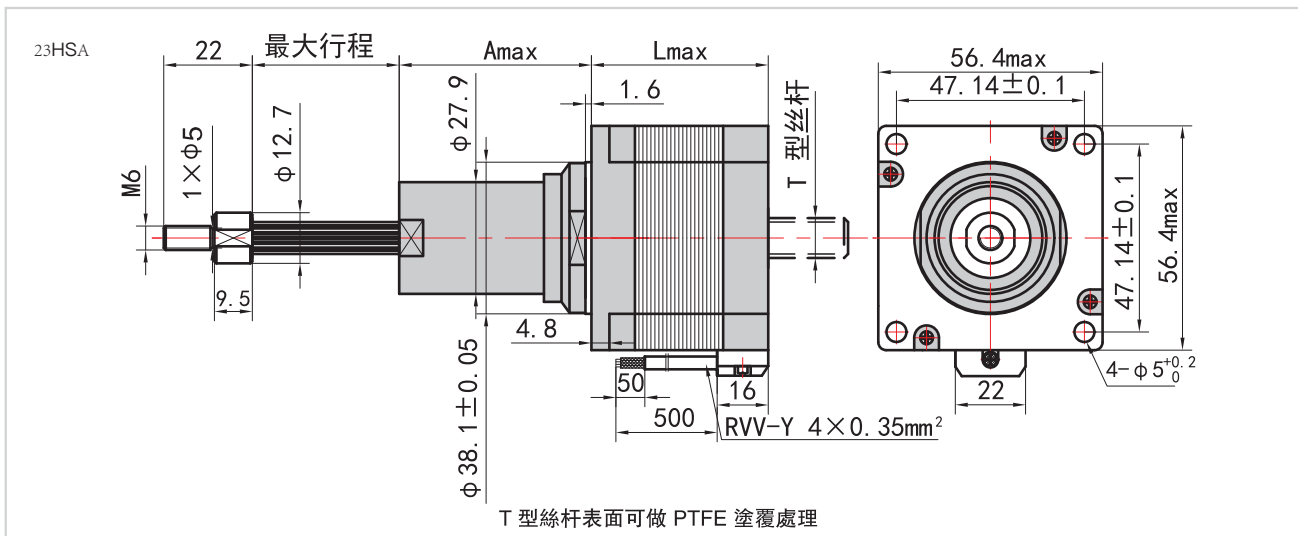

### DIMENSIONS (IN MM)

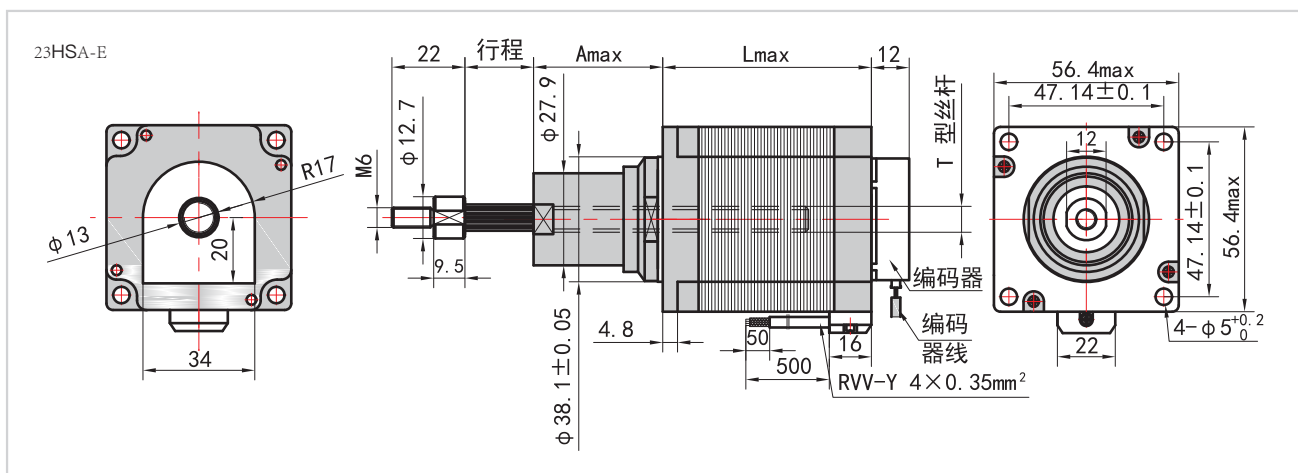

## 86系列外驱式直线电机-34HS

External Linear Actuator With T-Screw – NEMA 23

Nema34集成梯形丝杠电机，不带联轴器，电机与丝杠直接连接。提供多种电机高度版本。还提供用于位置反馈的内置编码器。

Nema34 integrated T screw motor, without coupling, the motor and screw are directly connected. Two motor height versions available. Screws of different lengths available. A built-in encoder for position feedback is also available.

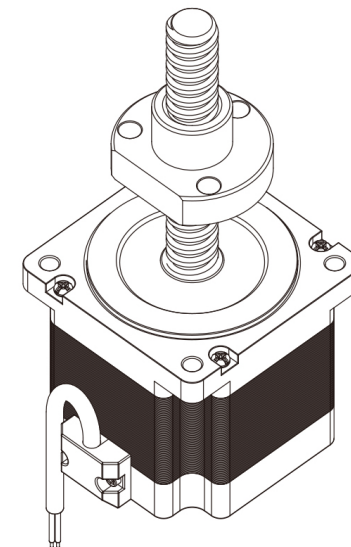

### Feature

- Integrated structure 一体化结构
- Multiple specifications available 提供多种规格
- Longer life and higher accuracy 更长的寿命和更高的精度
- Different lengths available 提供不同长度
- A built-in encoder available. 提供内置编码器。
- Motor Controllers / Drives available 电机控制器/驱动器可用
- 0.0002mm/step with our controlle 使用控制器时, 0.0002mm /步

### VERSIONS

系列代码 Series models	34HS76	34HS98
相电流 Current per Winding A	4	6
静力矩 Holding Torque mN.m	3500	7000
相电阻 Resistance per Winding Ohm	0.5	0.4
相电感 Inductance per Winding mH	3.7	3.8
转子惯量 Rotor Inertia gcm <sup>2</sup>	1400	1700
电机重量 Weight kg	1.4	2.7
电机高度 Length "L" mm	76	98
螺杆长度 Screw length*L1	Different lengths available	
反馈装置 Feedback	Encoder(Closed-loop version)	

### 订货代号 ORDER IDENTIFIER

#### 34HS76T0502E2000-L1

T0502=Screw code  
丝杠代码

L1 = Screw length  
丝杠长度

E2000=Encoder resolution(Optional)编  
码器分辨率 (可选)

### 可选螺杆 Screw optional

Screw	Diameter	Screw lead	Step(mm)
T16-3	16	3	0.015
T18-3	18	3	0.015
T14-4	14	4	0.02

### 可选配件 ACCESSORIES

ZK-ENC-500 Encoder Cable 0.5m

Encoder: 500-4000PCR

Motor Controllers / Drives